

GUND (Geoid Undulation) = The height of the Geoid (MSL) above the Reference Ellipsoid (WGS 84) at the stated position.	
BEARINGS ARE MAGNETIC ELEVATIONS AND HEIGHTS ARE IN FEET	
ELEVATIONS IN FEET AMSL	317

RUNWAY/TAXIWAY/APRON PHYSICAL CHARACTERISTICS

APRON / RWY / TWY	SURFACE	PCN	ELEVATION
RWY 08/26	Macadam	-	-
Main Apron	Tarmac	-	-
Main Taxiway	Grass	-	-

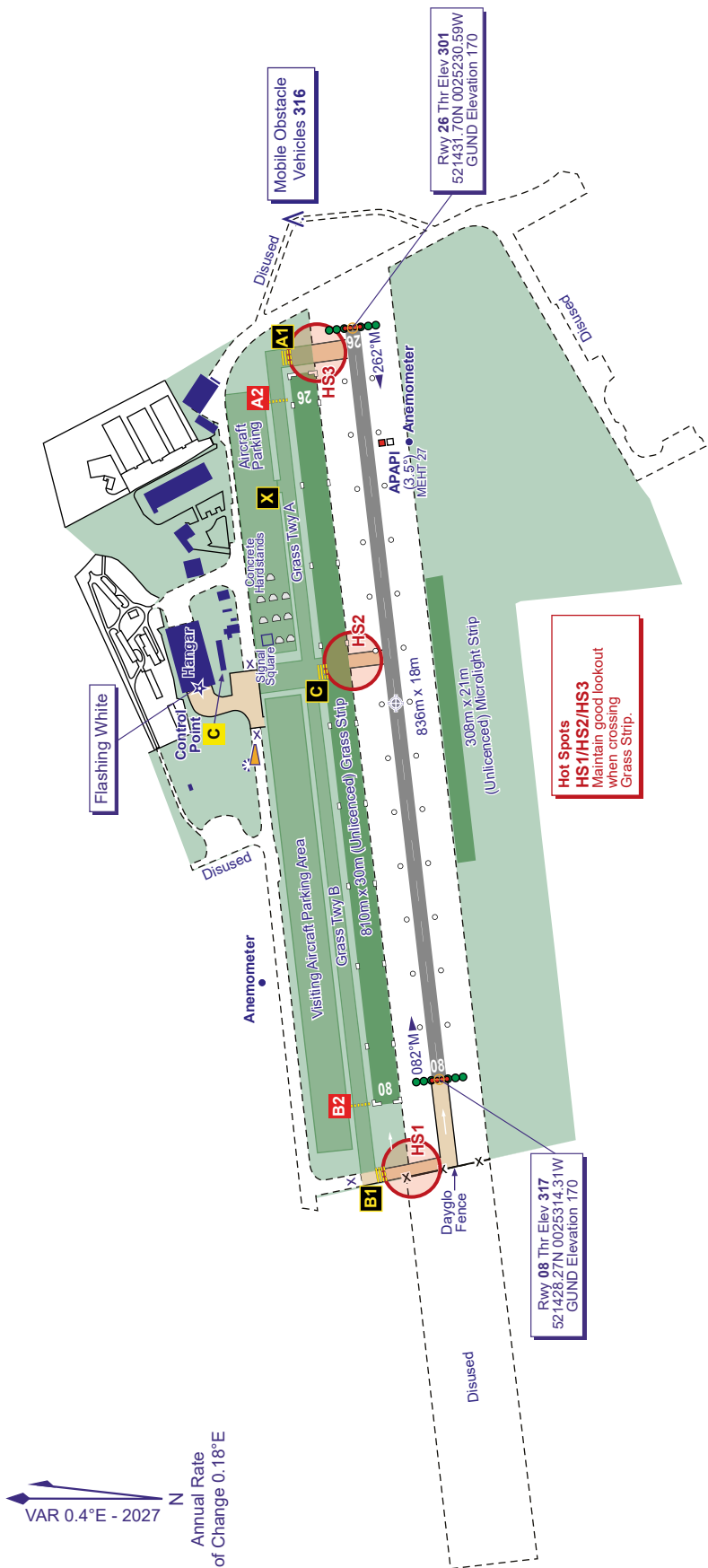

COM		SHOBDON INFO	
AFIS	118.155		SHOBDON RADIO
A/G	118.155		
LIGHTING			
THR 08/26	LI green.		
RWY 08/26	LI edge. LI red end lights.		